



BEFORE YOU BEGIN

Ensure that fence footings **do not exceed legally established property lines**. If uncertain, refer to your real estate line plot or consult a professional surveyor.

Check local codes for specifications regarding frontage locations, allowable fence heights, etc. A permit may be required.

Consult with local utility companies for locations of underground cables or pipelines.



SAFETY FIRST!

NOTE: The information contained in these guidelines is intended to provide general guidance with basic PostMaster® fence installation. The installer **must take proper safety precautions**. If you have any questions or doubts in regards to your fence installation, please consult with a licensed professional.

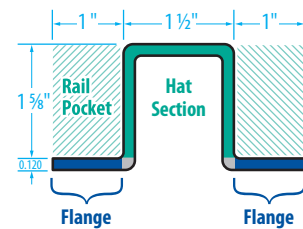

SPECIFICATIONS

- Size:** 3 1/2" x 1 3/8"
88.9 mm x 44.5 mm
- Holes:** 0.20" dia./1" O.C.
5.1 mm/1.54 cm O.C.)
- Thickness:** .120" (3.05 mm)
- Weight:** 2.64 lbs/ft (3.93 kg/m)
- Material:** G90 Galvanized Steel
- Lengths:** 6', 7', 7'6", 8', 9', 10', 12'

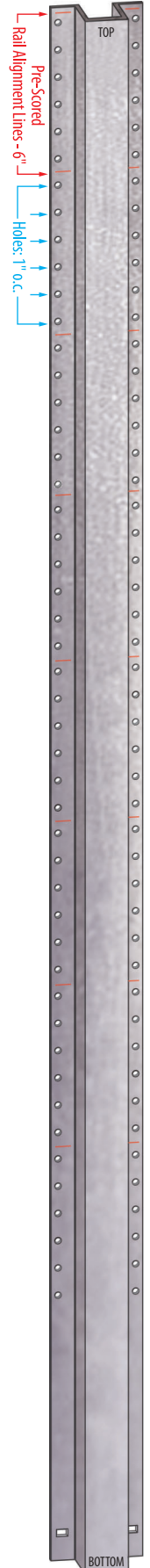

1 Plan, Layout & Mark

Locate your property's boundary lines.

Precisely mark the fence layout – it's the critical first step in a quality installation. Mark the location of each **terminal post** with a stake (corner, end & gateposts are called terminal posts).

When using 8 foot 2 x 4 rails, inline posts should be spaced 97 1/2" (8 feet + 1 1/2") on center, ±1/8". The exact spacing may be modified depending on rails used, fence height and ground slope.

Place shorter sections at the corners or near gates or buildings to make the fence fit the length of the layout.

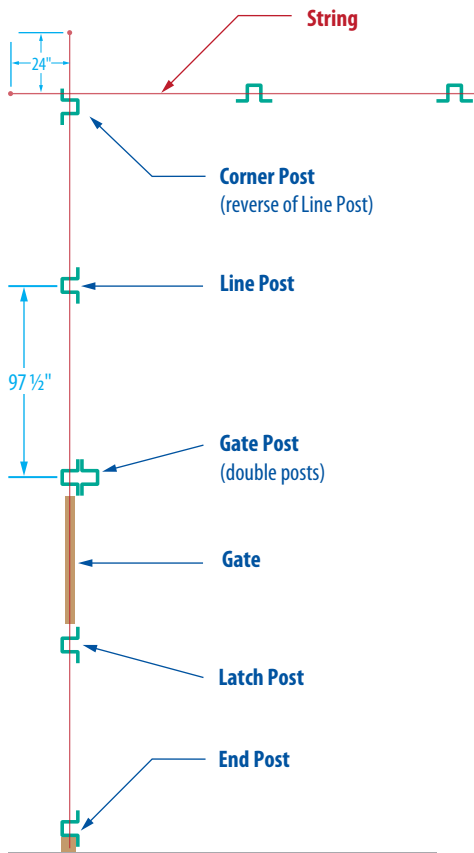

2 Locate & Set Posts

6' Fence / 7' 6" Post Shown
Fence Height: 74" • Post Height: 66"

Dig the terminal post holes 6" - 10" in diameter and 30" deep. The exact diameter and depth will be determined by local conditions.

The height of fence boards should be 8 in. above the top of the top rail and 8 inches below the bottom of the bottom rail with a 2 inch gap at the bottom between the fence board and ground.

If posts are too tall after footing installation, saw the excess PostMaster to be flush with the top of the top rail using a hacksaw or reciprocating saw.

Center the terminal posts in the holes. Make sure the posts are plumb, square to the fence line and set to the correct height. Block and support the post to preserve post position as installation continues.

Fill the hole with concrete in a continuous pour, mounding the top to direct water away from the post.

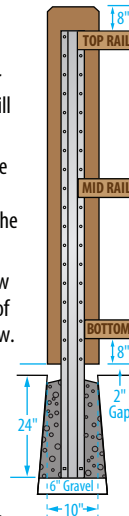

Make a Gate Post by fastening two PostMaster® posts back to back with four #12 x 1/2" gate post screws. Put one screw in each flange, 6" below the upper edge. Put two screws in the flanges 6" above the base of the bottom rail.

Place the assembled gate post in its hole, ensuring that its rail pockets will line up with the adjacent posts when installed. Pour concrete as with Terminal Posts.

When the terminal and gate post concrete has hardened, stretch a string between them to set the line posts at the correct height.

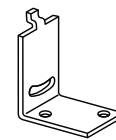
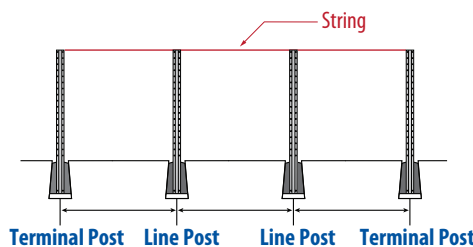

Post Clip
#633675

For use on all corner post applications to properly secure rails.



Rail Screw
#10 x 1 1/4"
#633671



Rail Screw
#8 x 1 1/4"
#633670



Cover Screw
#8 x 3/4"
#633669



Hex Head Gate Post Screw
#12 x 1/2"
#633673



8" Strap Hinge: #011186



8" Half Strap Hinge: #011015



5/8" x 6" Hanger Bolt: #013904



A Tradition of Fencing Solutions

masterhalco.com • 888-289-3362

3 Install Rails

Once all posts are set, attach rails according to the selected fence style. Typical fence boards are positioned 2" above ground level and top rails installed 8" from the top of the boards. Bottom rails are attached 8" above the board bottom and middle rails are centered between the top and bottom rails.

Determine where to attach rails. PostMaster posts have holes, 1" on center to make it easier to align rails at either end. For rail adjustment references, use the *pre-marked rail alignment scores* spaced 6 inch on center and starting ¼" from the top of the post.

Line Post

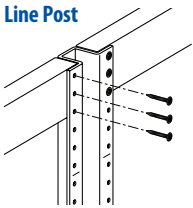

Fasten each rail-end using three #8 x 1 ¼" rail screws.

NOTE: If the ground slopes, be sure to cut both rail-ends diagonally to allow a flush fit against the rail pocket of the hat section. Post clips may be required for fastening.

Attach rails to Corner Posts, using one **Post Clip** per rail-end. Screw one #8 x 1 ¼" rail screw through the flange and into the rail-end. Screw a second #8 x 1 ¼" rail screw through the flange and semi-circular post clip hole and into the rail end.

Fasten the bottom edges of the top and middle rails to the post clip with two more #8 x 1 ¼" rail screws.

For the bottom rail, position the post clip above rail so it can be screwed to the rail's top edge.

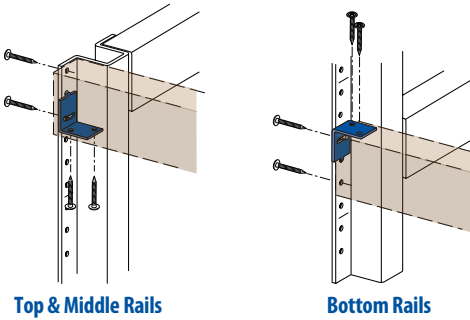

Top & Middle Rails

Bottom Rails

4 Install Corner Post Covers

Note: Install 4" cover boards *before* installing fence boards. Position cover board against backside of flanges and attach with ten #8 x ¾" cover screws - 5 through each flange.

1. Install POST Cover 2. Install CORNER Cover Board

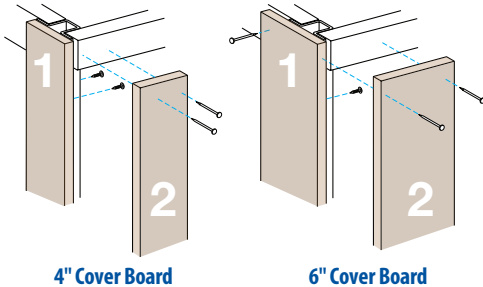

4" Cover Board

6" Cover Board

Line up edge of fence board with flange edge. Attach fence board by fastening five #8 x ¾" cover screws into flange, followed by five more screws into adjacent flange.

Line up edge of fence board with flange edge. Attach fence board by fastening five #8 x ¾" cover screws into fence board through flange in rail pocket.

5 Install Fence Boards

Nail fence boards to rails according to fence style.

6 Line, End & Gate Covers

Line Post

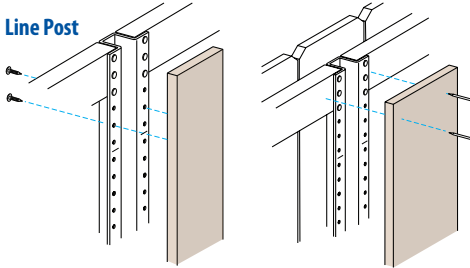

4" Cover Board

6" Cover Board

Install 6" cover boards after installing fence boards. Attach cover board by nailing into the rail on either side of the post

End Post

Fasten a **vertical 2 x 2** in rail pocket by nailing it through fence board. Attach cover board by nailing one side into 2 x 2 and the other side into fence rail.

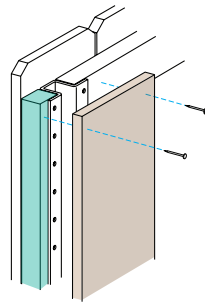

Gate Post

Use the numbering system below to identify the gate post pocket positions referenced in the following steps



SWING-OUT GATE

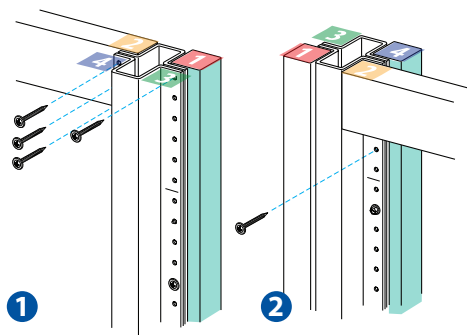

Attach a 2 x 2 in rail pocket #1 by fastening five #8 x 1 ¼" rail screws into it through flanges from rail pocket #3.

Diagonally attach a 2 x 2 in rail pocket #4 by fastening five #8 x 1-1/4" rail screws into it through flanges from rail pocket #2

Gate Post Cover Board

Attach a 2 x 2 to a cover board. Install the cover board so the 2 x 2 fits into rail pocket #3, and fasten the assembly in place by nailing into the 2 x 2 in rail pocket #4

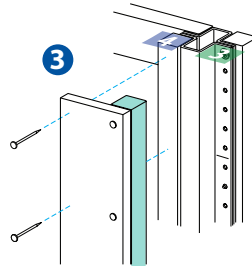

SWING-IN GATE

Attach a 2 x 2 in rail pocket #1 by fastening five #8 x 1 ¼ inch rail screws into it through flanges from rail pocket #3. Screws should be evenly spaced down the post.

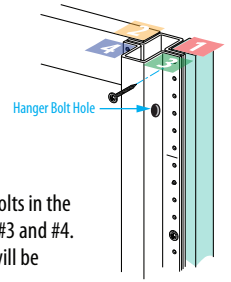

Drill two 5/8 inch holes for hanger bolts in the **hat section** between rail pockets #3 and #4. The hanger bolt adjustment nuts will be installed against the hat section.

Cut a 2 x 2 to appropriate lengths for **rail pocket #4**. Attach by fastening #8 x 1-1/4" rail screws into the 2 x 2 through flanges in rail pocket #2

Cut a 2 x 2 to appropriate lengths for **rail pocket #3** and nail to cover board.

Install the assembly so 2 x 2 fits into rail pocket #3, and fasten by nailing through cover board into 2 x 2 in rail pocket #4

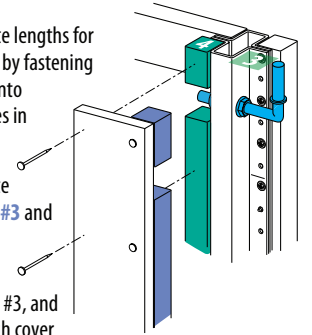

7 Install Gate Hardware

SWING-OUT GATE

Use 8" Ornamental strap hinge.

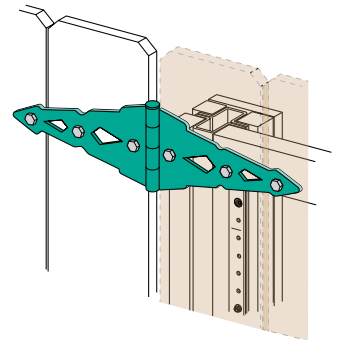

SWING-IN GATE

Use hanger bolt with 8" Ornamental strap hinge.

