

OWNERSHIP OF DOCUMENTS:

THIS DOCUMENT AND THE IDEAS AND DESIGNS INCORPORATED HEREIN, AS AN INSTRUMENT OF PROFESSIONAL SERVICE, IS THE PROPERTY OF JAMIESON MANUFACTURING CO. AND IS NOT TO BE USED IN WHOLE OR IN PART, FOR ANY OTHER PROJECT WITHOUT THE WRITTEN AUTHORIZATION OF JAMIESON MANUFACTURING CO.

LEGEND		
SHT	DESCRIPTION	LAYER
1	2-RAIL STERLING	S2
2	3-RAIL STERLING	S3
3	4-RAIL STERLING	S4

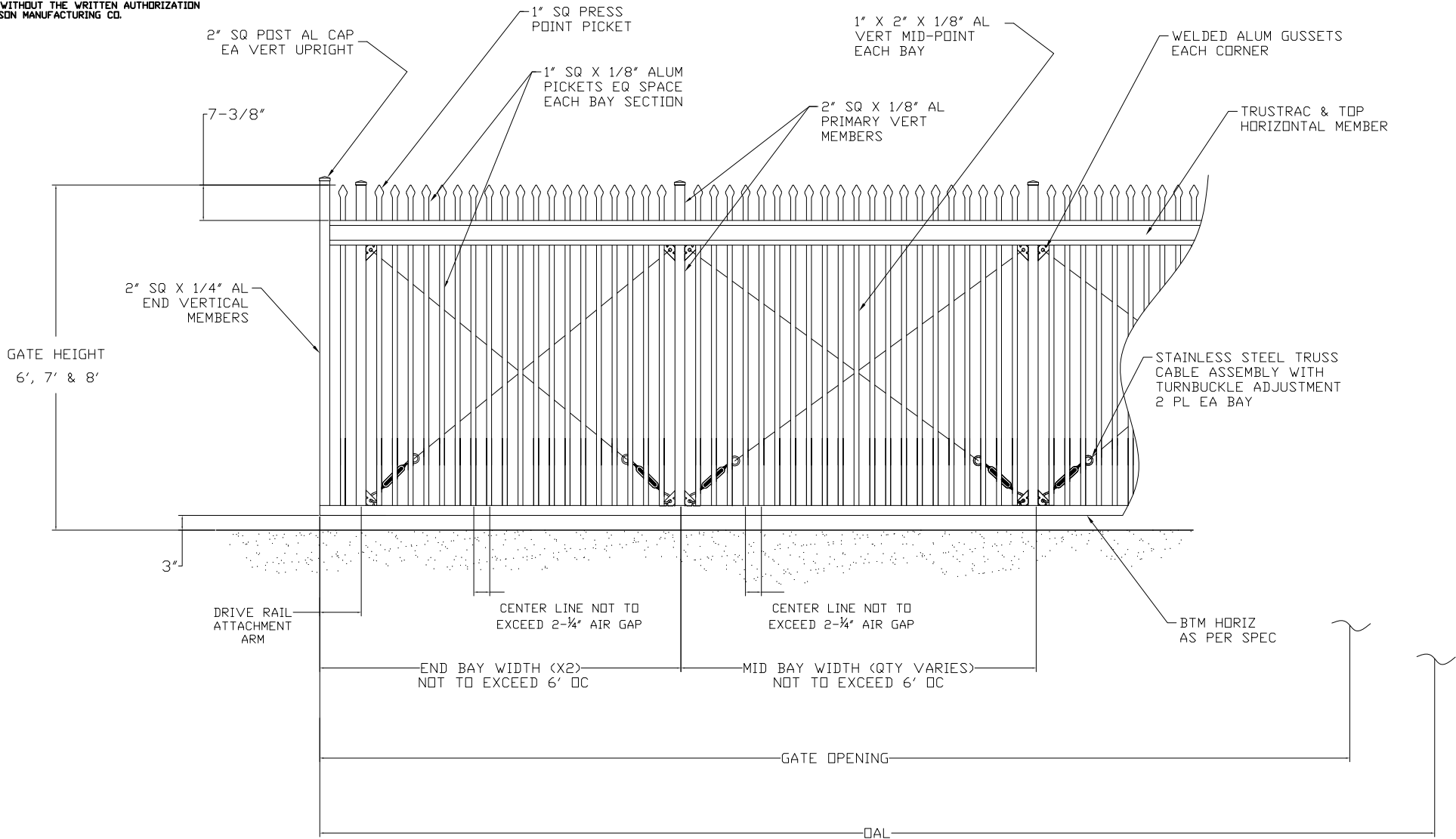

NOTE:

- 1) FILLER MATERIAL TO COVER ENTIRE LENGTH OF GATE FRAME, INCLUDING TAIL SECTION
- 2) ALL PICKET SPACING TO BE COMPLIANT TO ASTM F2200-02
- 3) PICKET SPACING TO BE EQUIDISTANT WITHIN EACH BAY



JAMIESON MANUFACTURING CO.

4221 PLATINUM WAY, DALLAS, TX 75237

PH: (713) 434-7907 / (888) 286-3362
 email: gates@jamiesonfence.com www.jamiesonfence.com

TRUSTRAC™ ORNAMENTAL CANTILEVER GATES

**STERLING 2-RAIL
 ORNAMENTAL GATE DETAIL**

DESIGNED BY
 JK

CHECKED JK

DRAWN JK

DATE: 11/18/13

SCALE: N/A

DWG NO.

TT_STERLING

REV. A

SHEET 1 OF 3

OWNERSHIP OF DOCUMENTS:

THIS DOCUMENT AND THE IDEAS AND DESIGNS INCORPORATED HEREIN, AS AN INSTRUMENT OF PROFESSIONAL SERVICE, IS THE PROPERTY OF JAMIESON MANUFACTURING CO. AND IS NOT TO BE USED IN WHOLE OR IN PART, FOR ANY OTHER PROJECT WITHOUT THE WRITTEN AUTHORIZATION OF JAMIESON MANUFACTURING CO.

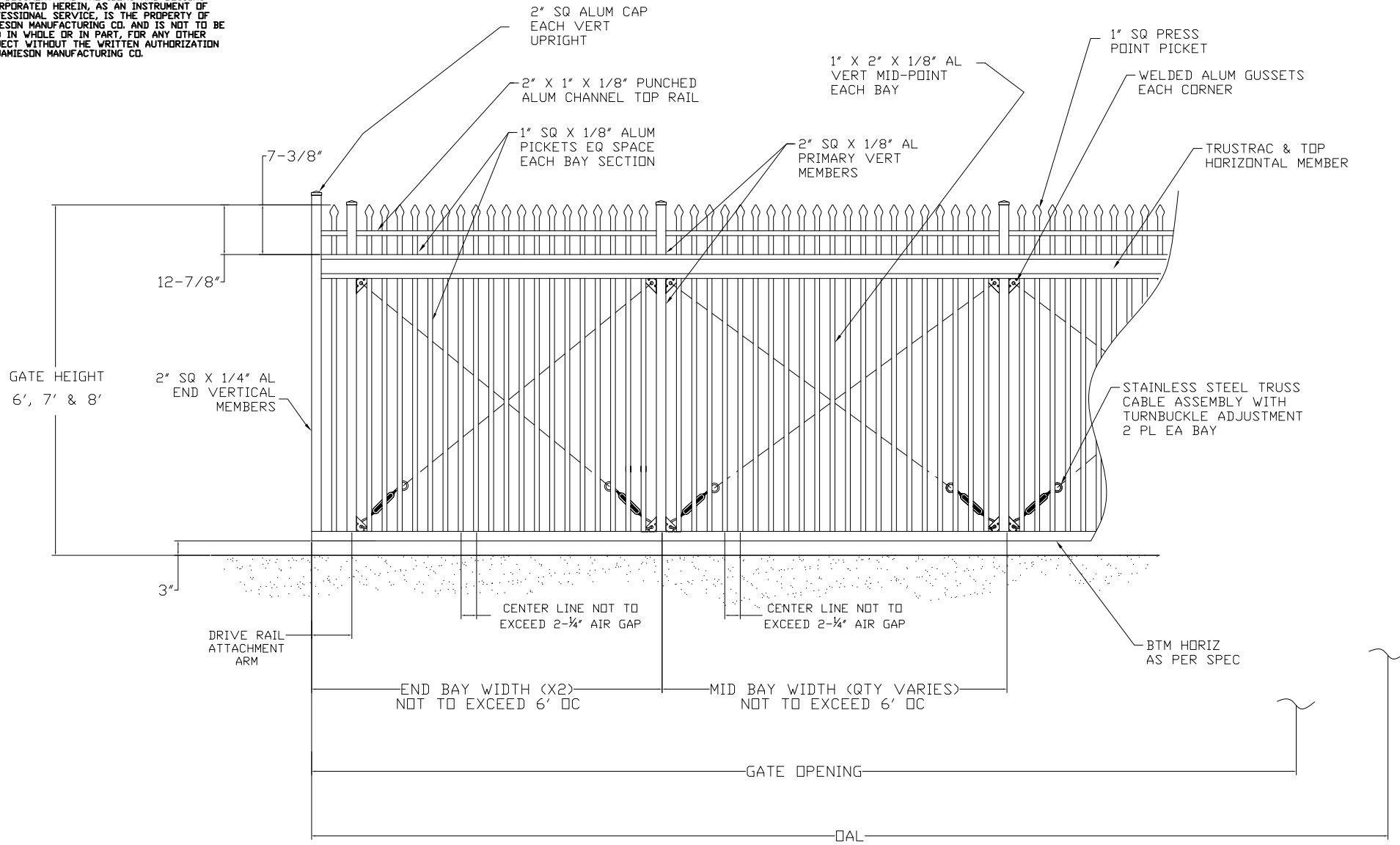

NOTE:

- 1) FILLER MATERIAL TO COVER ENTIRE LENGTH OF GATE FRAME, INCLUDING TAIL SECTION
- 2) ALL PICKET SPACING TO BE COMPLIANT TO ASTM F2200-02
- 3) PICKET SPACING TO BE EQUIDISTANT WITHIN EACH BAY



JAMIESON MANUFACTURING CO.

4221 PLATINUM WAY, DALLAS, TX 75237

PH: (713) 434-7907 / (888) 286-3362
 email: gates@jamiesonfence.com www.jamiesonfence.com

TRUSTRAC™ ORNAMENTAL CANTILEVER GATES

**STERLING 3-RAIL
 ORNAMENTAL GATE DETAIL**

DESIGNED BY JK	DWG NO. JTT-S3
CHECKED JK	
DRAWN JK	
DATE: 11/18/13	REV. A
SCALE: N/A	SHEET 2 OF 3

OWNERSHIP OF DOCUMENTS:

THIS DOCUMENT AND THE IDEAS AND DESIGNS INCORPORATED HEREIN, AS AN INSTRUMENT OF PROFESSIONAL SERVICE, IS THE PROPERTY OF JAMIESON MANUFACTURING CO. AND IS NOT TO BE USED IN WHOLE OR IN PART, FOR ANY OTHER PROJECT WITHOUT THE WRITTEN AUTHORIZATION OF JAMIESON MANUFACTURING CO.

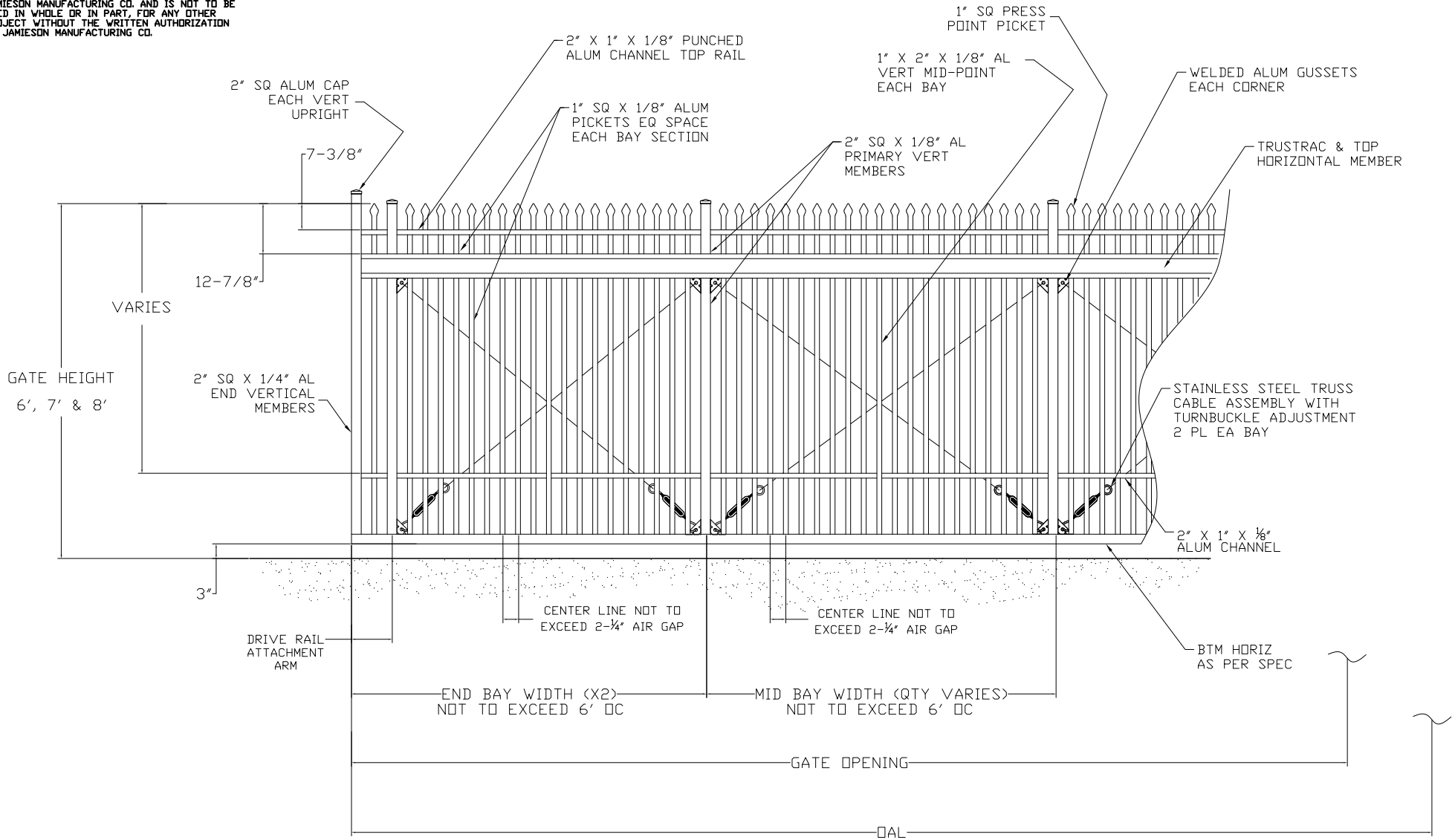

NOTE:

- 1) FILLER MATERIAL TO COVER ENTIRE LENGTH OF GATE FRAME, INCLUDING TAIL SECTION
- 2) ALL PICKET SPACING TO BE COMPLIANT TO ASTM F2200-02
- 3) PICKET SPACING TO BE EQUIDISTANT WITHIN EACH BAY



JAMIESON MANUFACTURING CO.

4221 PLATINUM WAY, DALLAS, TX 75237

PH: (713) 434-7907 / (888) 286-3362
 email: gates@jamiesonfence.com www.jamiesonfence.com

TRUSTRAC™ ORNAMENTAL CANTILEVER GATES

**STERLING 4-RAIL
 ORNAMENTAL GATE DETAIL**

DESIGNED BY JK
CHECKED JK
DRAWN JK
DATE: 11/18/13
SCALE: N/A

DWG NO. JTT-S4
REV. A
SHEET 3 OF 3