

**OWNERSHIP OF DOCUMENTS:**

THIS DOCUMENT AND THE IDEAS AND DESIGNS INCORPORATED HEREIN, AS AN INSTRUMENT OF PROFESSIONAL SERVICE, IS THE PROPERTY OF JAMIESON MANUFACTURING CO. AND IS NOT TO BE USED IN WHOLE OR IN PART, FOR ANY OTHER PROJECT WITHOUT THE WRITTEN AUTHORIZATION OF JAMIESON MANUFACTURING CO.

LEGEND		
SHT	DESCRIPTION	LAYER
1	2-RAIL COLUMBIA	C2
2	3-RAIL COLUMBIA	C3
3	4-RAIL COLUMBIA	C4

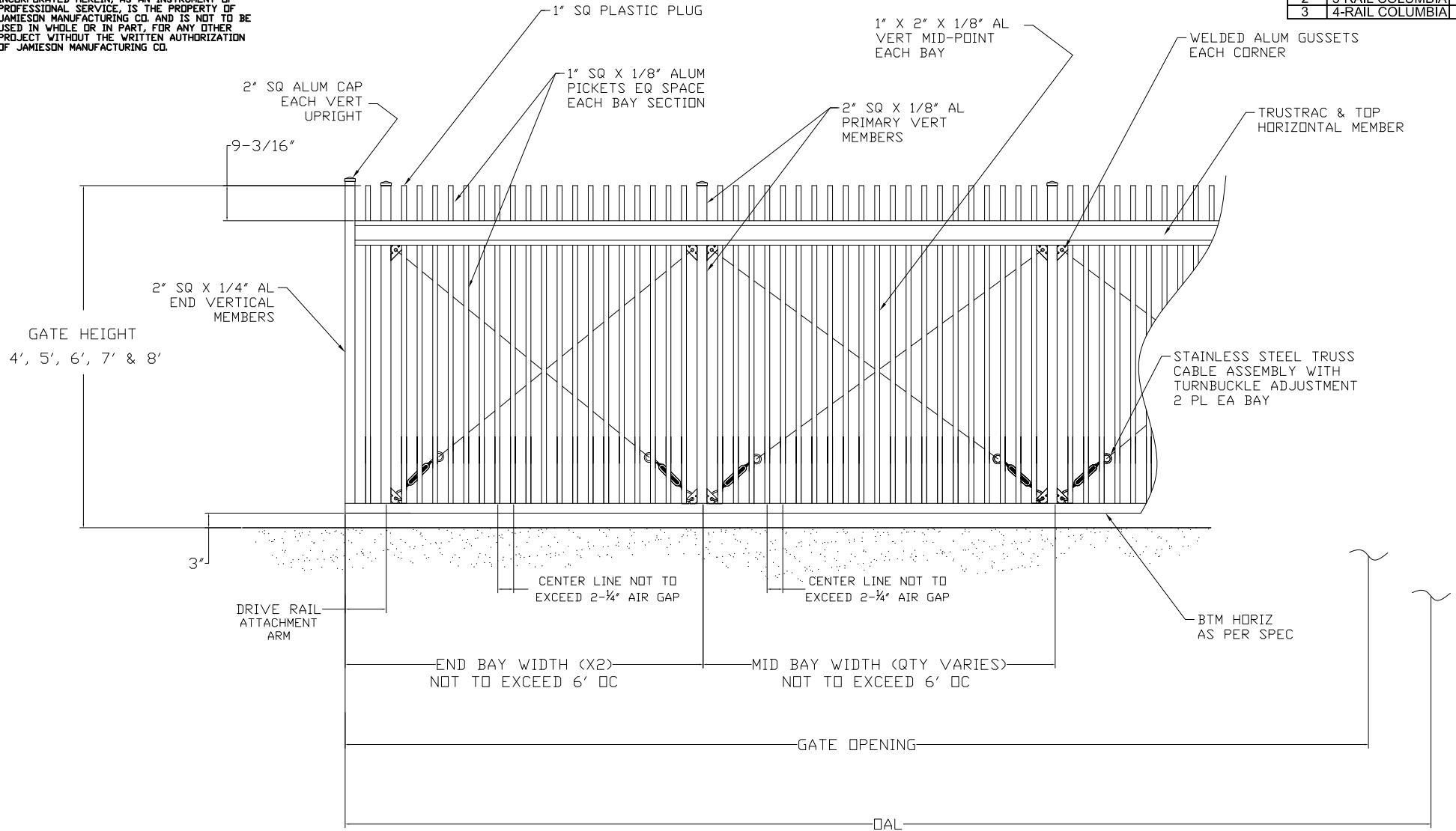

**NOTE:**

- 1) FILLER MATERIAL TO COVER ENTIRE LENGTH OF GATE FRAME, INCLUDING TAIL SECTION
- 2) ALL PICKET SPACING TO BE COMPLIANT TO ASTM F2200-02
- 3) PICKET SPACING TO BE EQUIDISTANT WITHIN EACH BAY



**JAMIESON MANUFACTURING CO.**  
 4221 PLATINUM WAY, DALLAS, TX 75237  
 PH: (713) 434-7907 / (888) 286-3362  
 email: gates@jamiesonfence.com www.jamiesonfence.com

**TRUSTRAC™ ORNAMENTAL CANTILEVER GATES**

**COLUMBIA 2-RAIL  
 ORNAMENTAL GATE DETAIL**

DESIGNED BY JK	DWG NO. TT_COLUMBIA
CHECKED JK	
DRAWN JK	
DATE: 11/18/13	REV. A
SCALE: N/A	SHEET 1 OF 3

**OWNERSHIP OF DOCUMENTS:**

THIS DOCUMENT AND THE IDEAS AND DESIGNS INCORPORATED HEREIN, AS AN INSTRUMENT OF PROFESSIONAL SERVICE, IS THE PROPERTY OF JAMIESON MANUFACTURING CO. AND IS NOT TO BE USED IN WHOLE OR IN PART, FOR ANY OTHER PROJECT WITHOUT THE WRITTEN AUTHORIZATION OF JAMIESON MANUFACTURING CO.

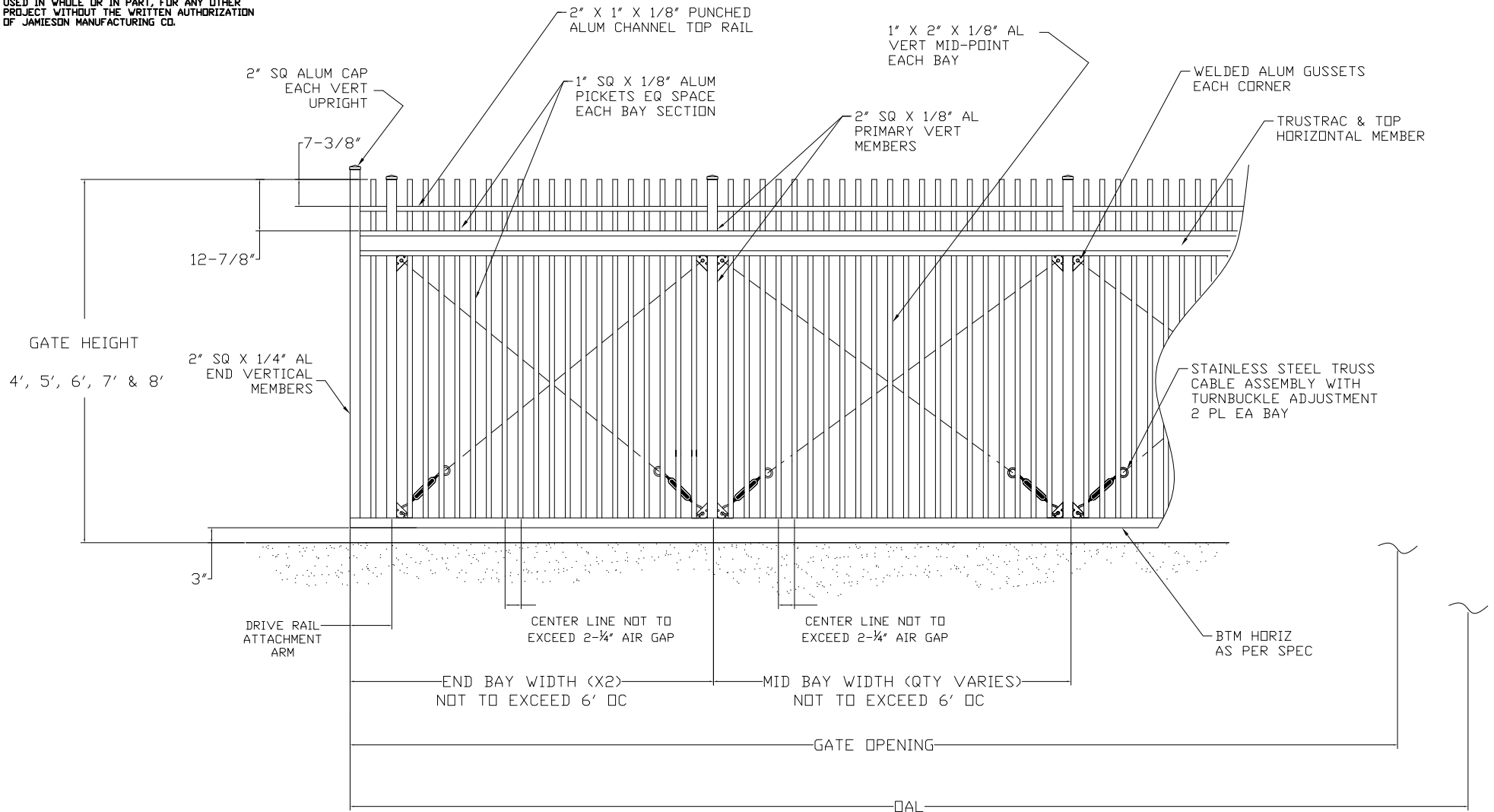

**NOTE:**

- 1) FILLER MATERIAL TO COVER ENTIRE LENGTH OF GATE FRAME, INCLUDING TAIL SECTION
- 2) ALL PICKET SPACING TO BE COMPLIANT TO ASTM F2200-02
- 3) PICKET SPACING TO BE EQUIDISTANT WITHIN EACH BAY



**JAMIESON MANUFACTURING CO.**

4221 PLATINUM WAY, DALLAS, TX 75237

PH: (713) 434-7907 / (888) 286-3362  
 email: gates@jamiesonfence.com www.jamiesonfence.com

**TRUSTRAC™ ORNAMENTAL CANTILEVER GATES**

**COLUMBIA 3-RAIL  
 ORNAMENTAL GATE DETAIL**

DESIGNED BY JK	DWG NO.  JTT-C3
CHECKED JK	
DRAWN JK	
DATE: 11/18/13	REV. A
SCALE: N/A	SHEET 2 OF 3

**OWNERSHIP OF DOCUMENTS:**

THIS DOCUMENT AND THE IDEAS AND DESIGNS INCORPORATED HEREIN, AS AN INSTRUMENT OF PROFESSIONAL SERVICE, IS THE PROPERTY OF JAMIESON MANUFACTURING CO. AND IS NOT TO BE USED IN WHOLE OR IN PART, FOR ANY OTHER PROJECT WITHOUT THE WRITTEN AUTHORIZATION OF JAMIESON MANUFACTURING CO.

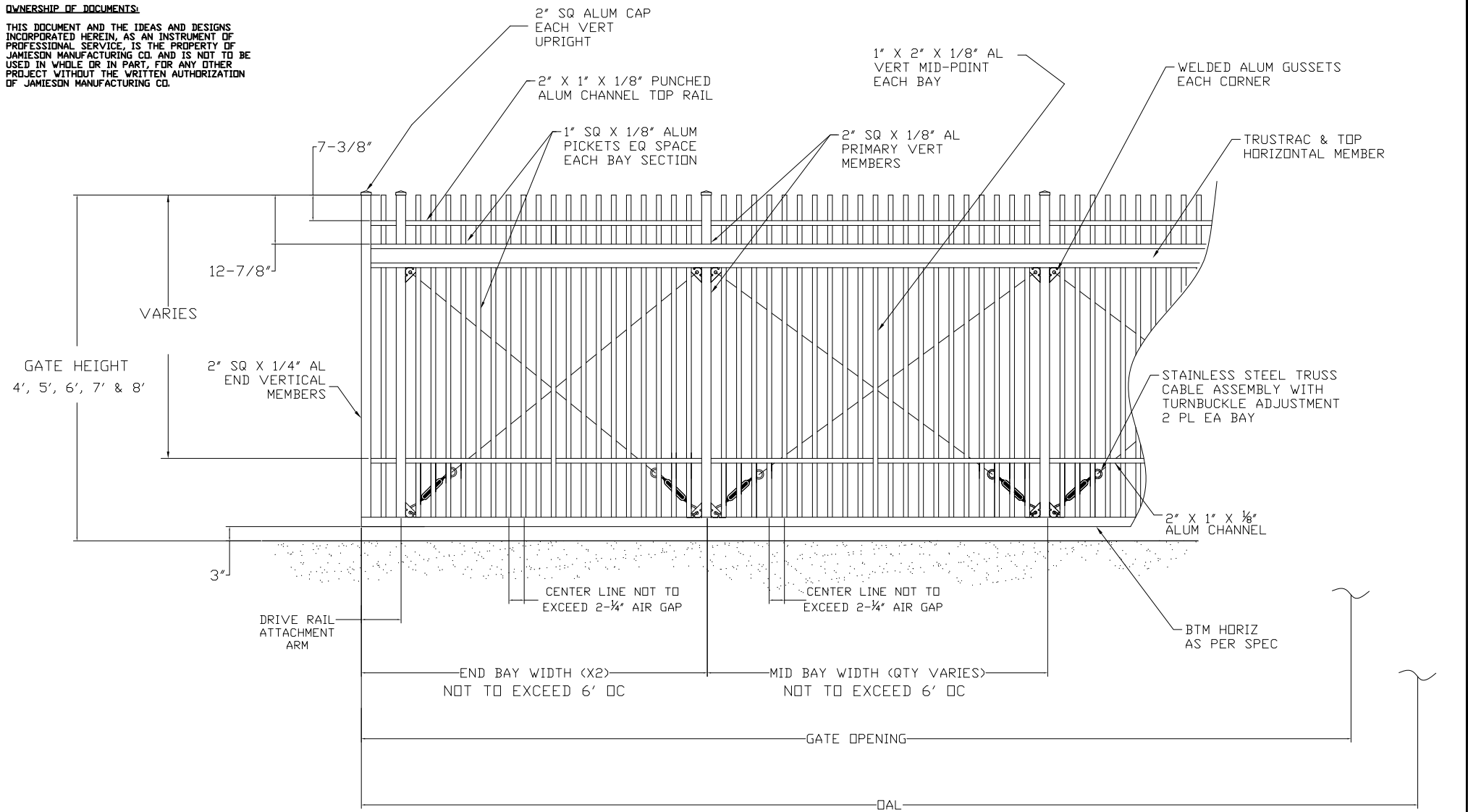

**NOTE:**

- 1) FILLER MATERIAL TO COVER ENTIRE LENGTH OF GATE FRAME, INCLUDING TAIL SECTION
- 2) ALL PICKET SPACING TO BE COMPLIANT TO ASTM F2200-02
- 3) PICKET SPACING TO BE EQUIDISTANT WITHIN EACH BAY



**JAMIESON MANUFACTURING CO.**

4221 PLATINUM WAY, DALLAS, TX 75237

PH: (713) 434-7907 / (888) 286-3362  
 email: gates@jamiesonfence.com www.jamiesonfence.com

**TRUSTRAC™ ORNAMENTAL CANTILEVER GATES**

**COLUMBIA 4-RAIL  
 ORNAMENTAL GATE DETAIL**

DESIGNED BY JK	DWG NO.  JTT-C4
CHECKED JK	
DRAWN JK	
DATE: 11/18/13	REV. A
SCALE: N/A	SHEET 3 OF 3